



Yamaha FRZ 750 R (OW01) (Tamiya 14058) – brakes upgrade set

Catalog no.: FSM P012

Installation guide

Parts list: thin metal wire x 1, thick metal wire x 1, black wire x 1, metal rotors x3.

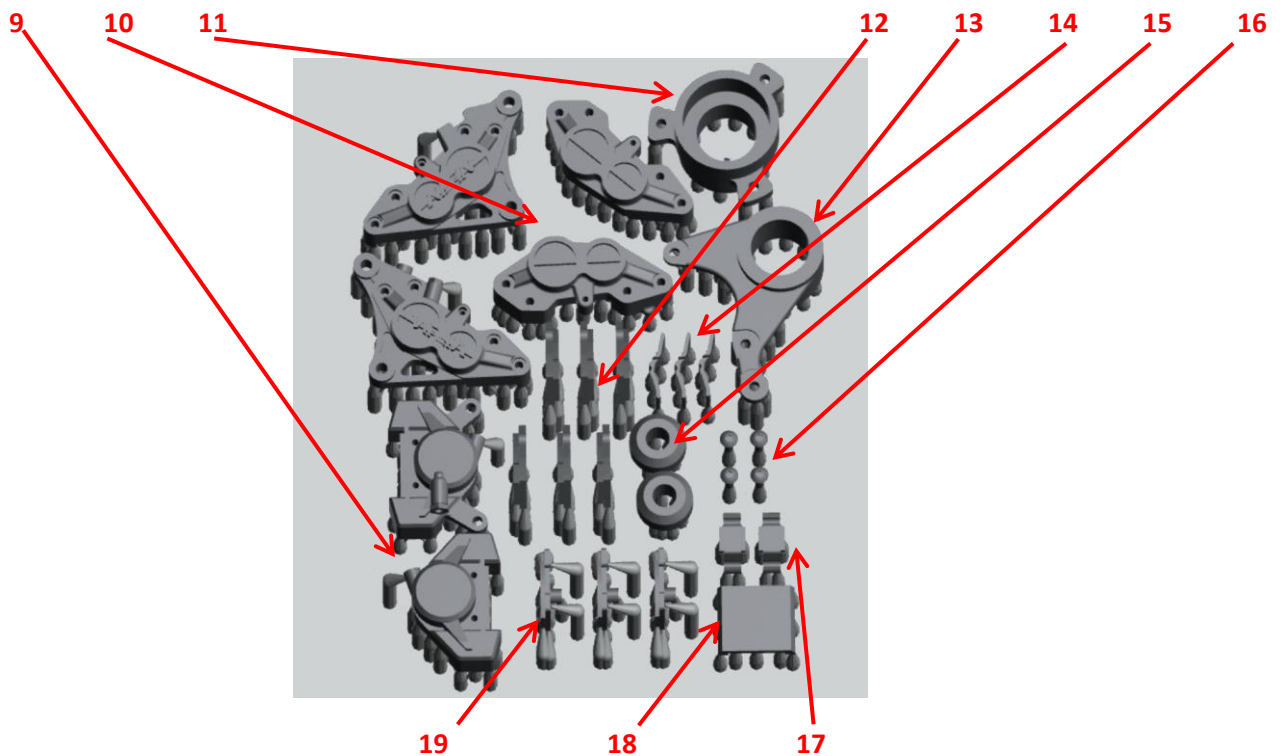
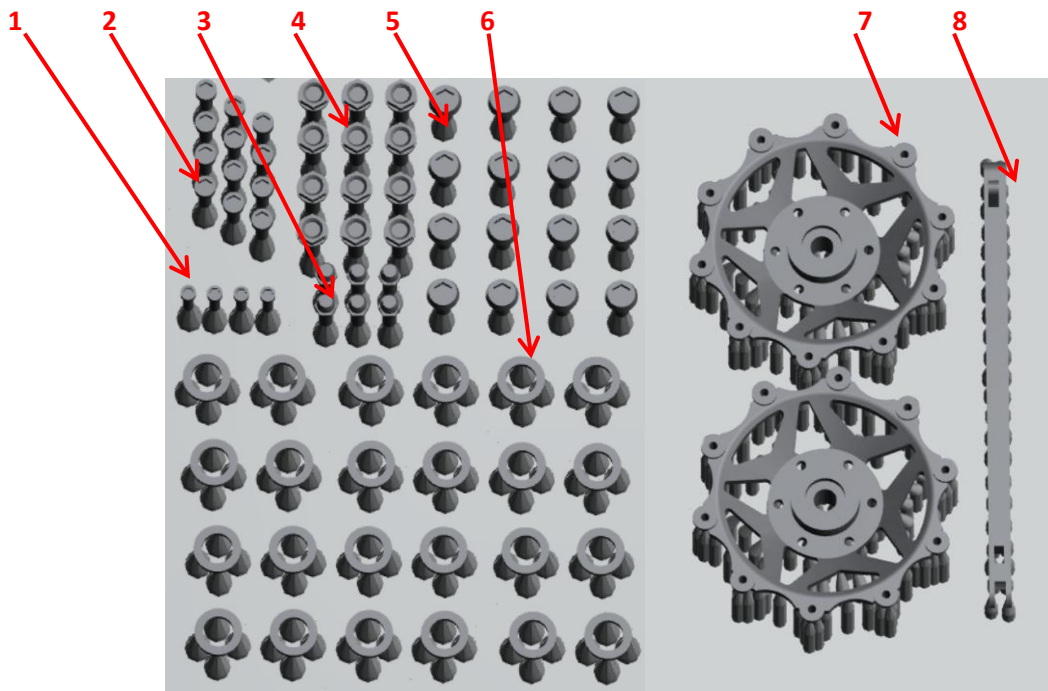

Part no.	Part name	Part no.	Part name
1	Front caliper small screw x 4	11	Rear hub x1
2	Front caliper big screw x 12	12	Front brake pads (left x3, right x3)
3	Bleeding screw x6	13	Rear caliper holder x1
4	Screws x12	14	Front brake pads tensioning plate x3
5	Front rotor screws x16	15	Front rotor hub spacer x2
6	Front rotor rings x 24	16	Rear rotor screws x4
7	Front rotor hub x 2	17	Rear brake pads tensioning plate x2
8	Rear brake stiffener x1	18	Rear caliper cover x1
9	Rear caliper (inner x1, outer x1)	19	Rear brake pads x3
10	Front caliper (inner x2, outer x2)		

It is suggested to cut off all parts except screws which can be painted as attached to the print base.

Use CA glue to join resin parts with the ones from the base kit.

Use sand paper to polish the rotors.

Contents

Rear brake	3
Front brake	6

Rear brake

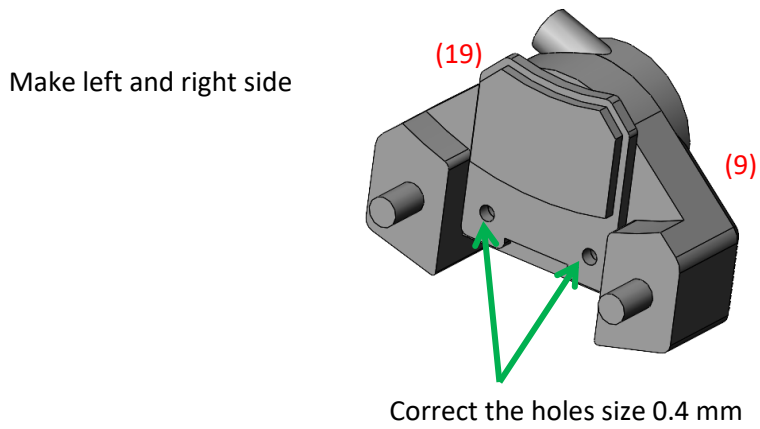
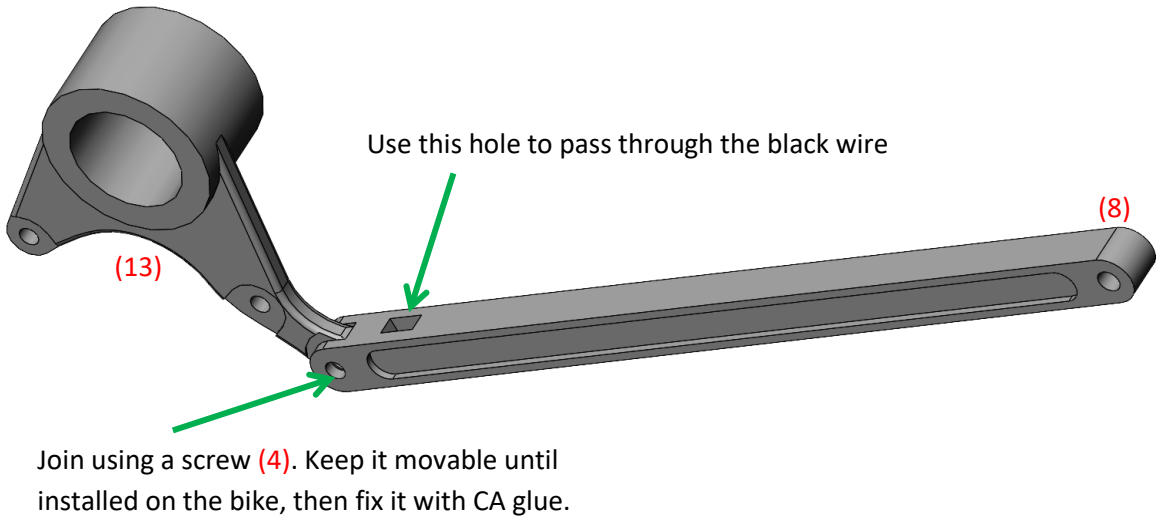
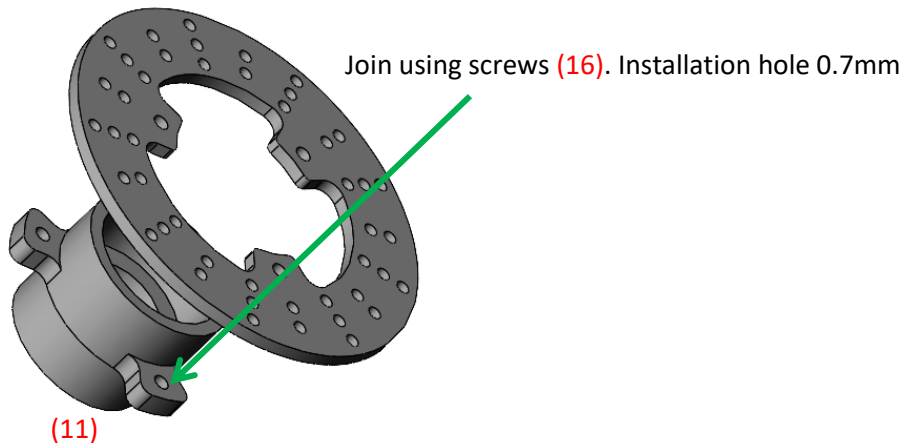

Hole diam. 0.5 mm. Install bleeding screws (3)

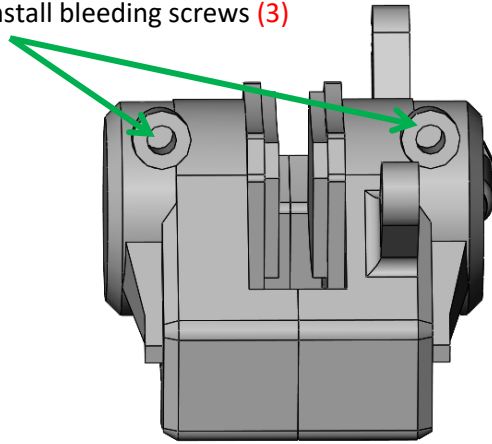

Use thin metal wire to recreate pins

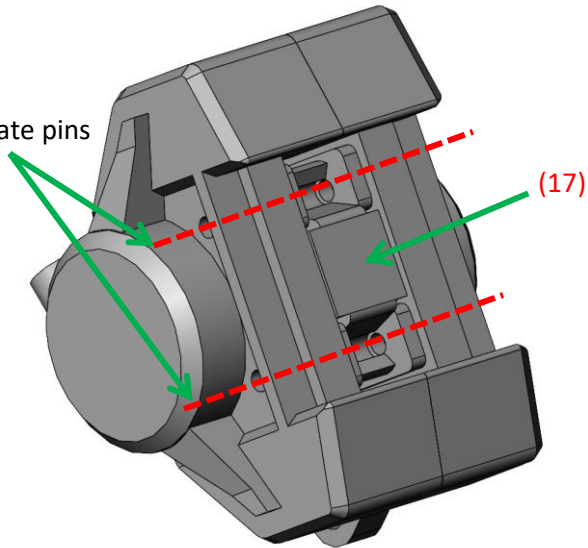

(18)

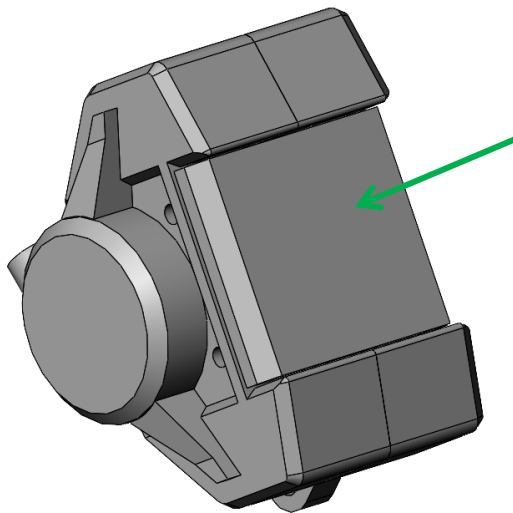

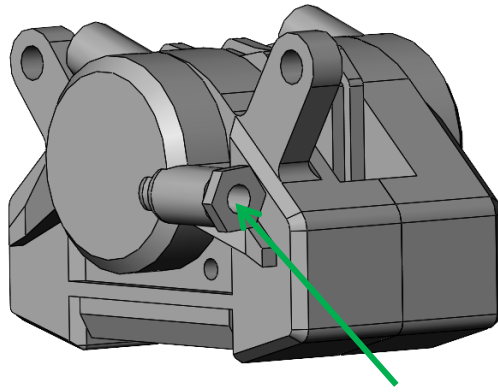

Correct the hole size: 0.5 mm followed by 0.6 mm

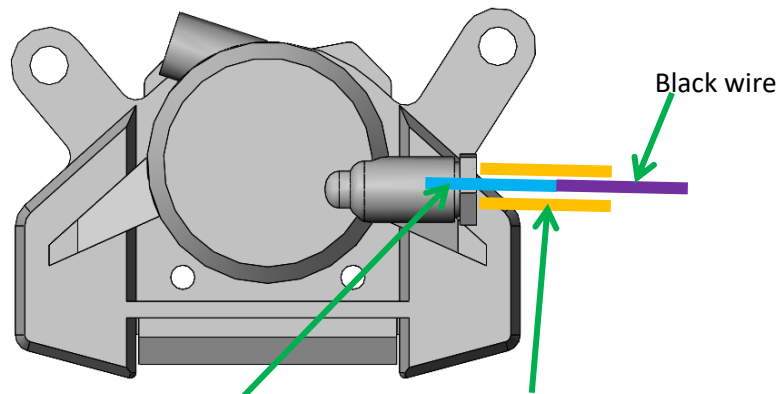

Black wire

Vinyl tube from the base kit

Thick metal wire – 2mm

Join using a screws (4).

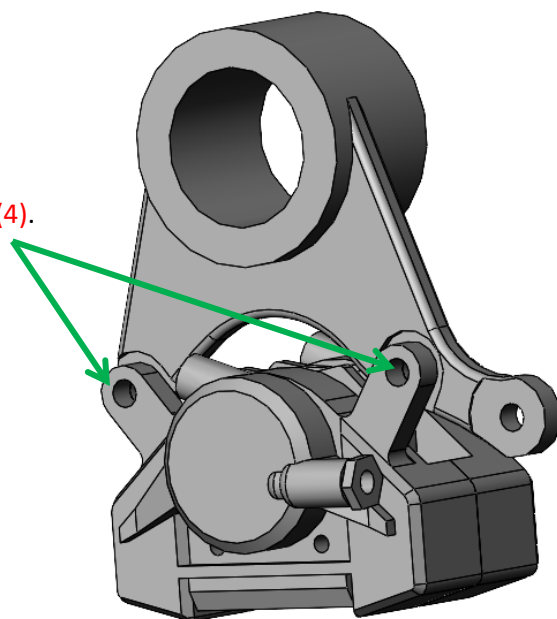

Front brake

Make 2

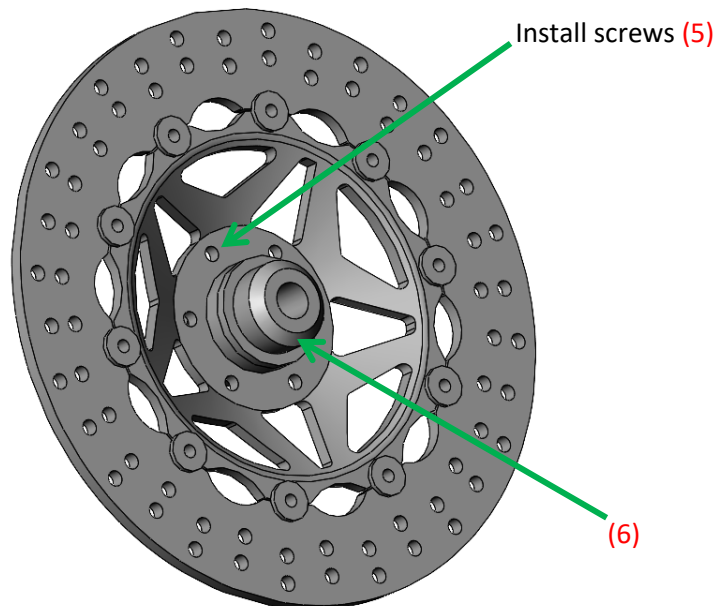
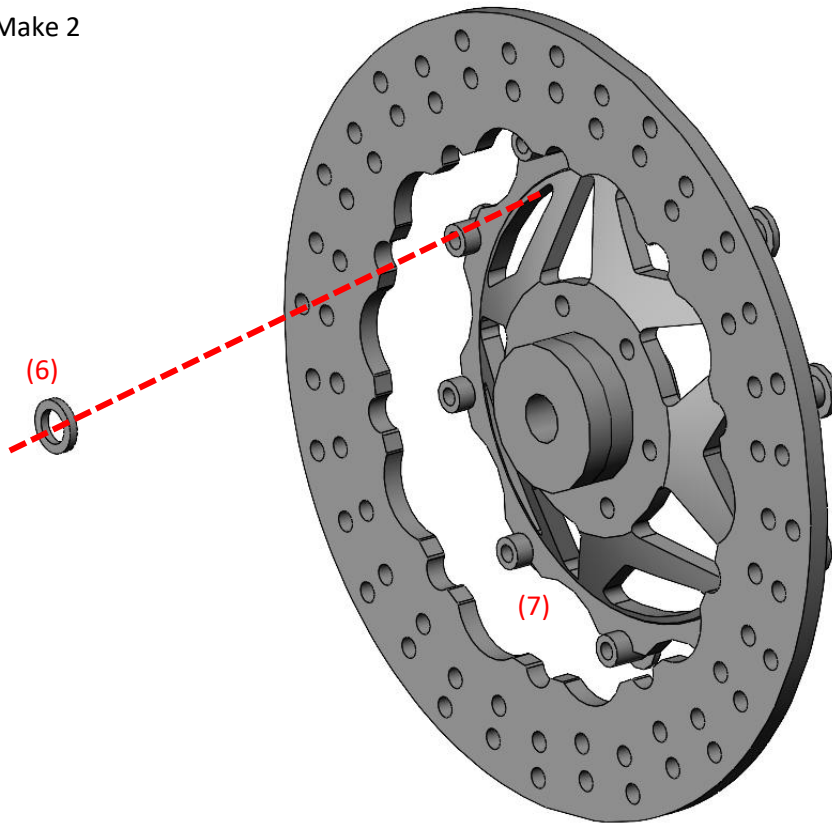

Cut off the brake caliper

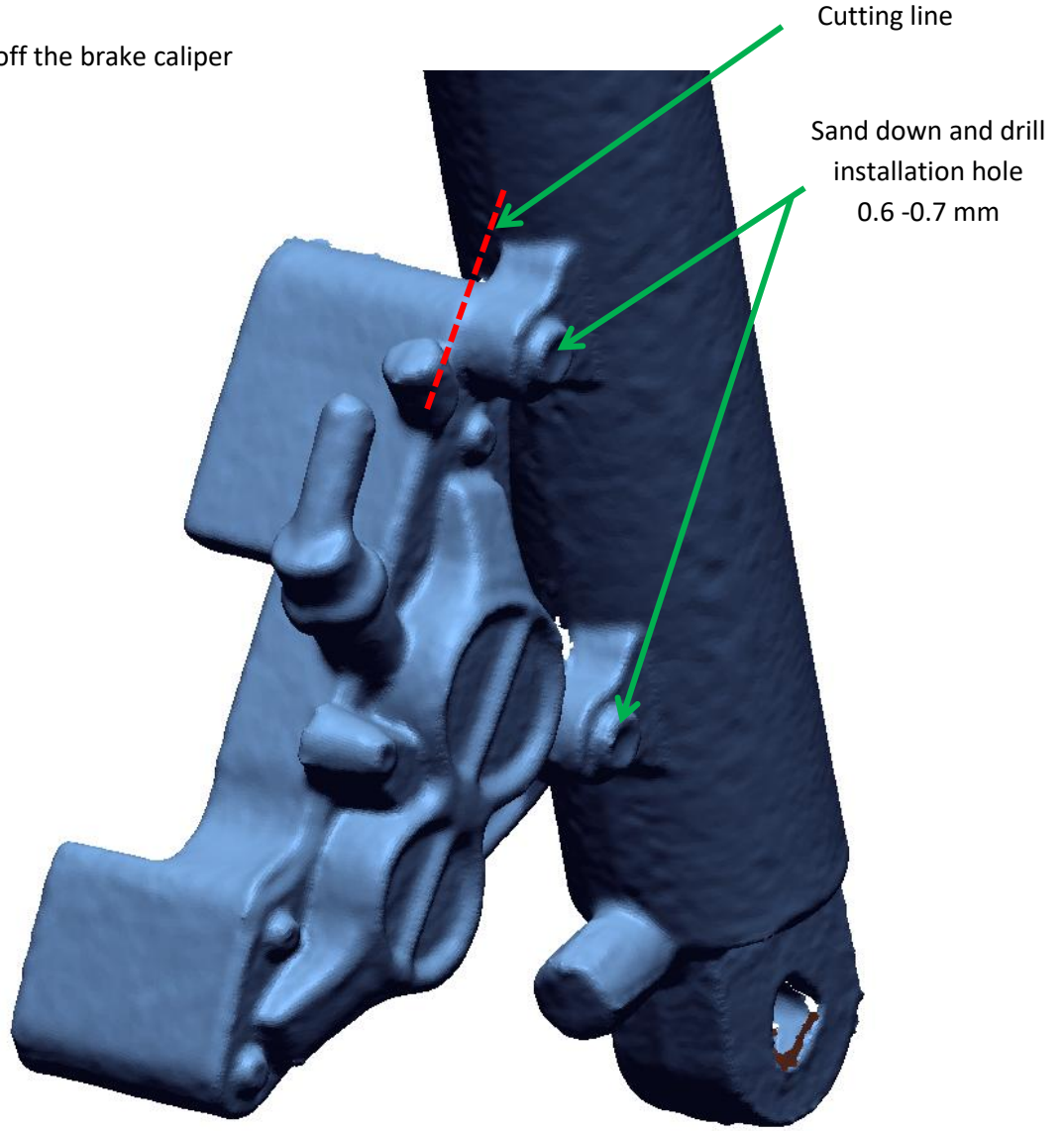

Hole diam. 0.5 mm. Install bleeding screws (3)

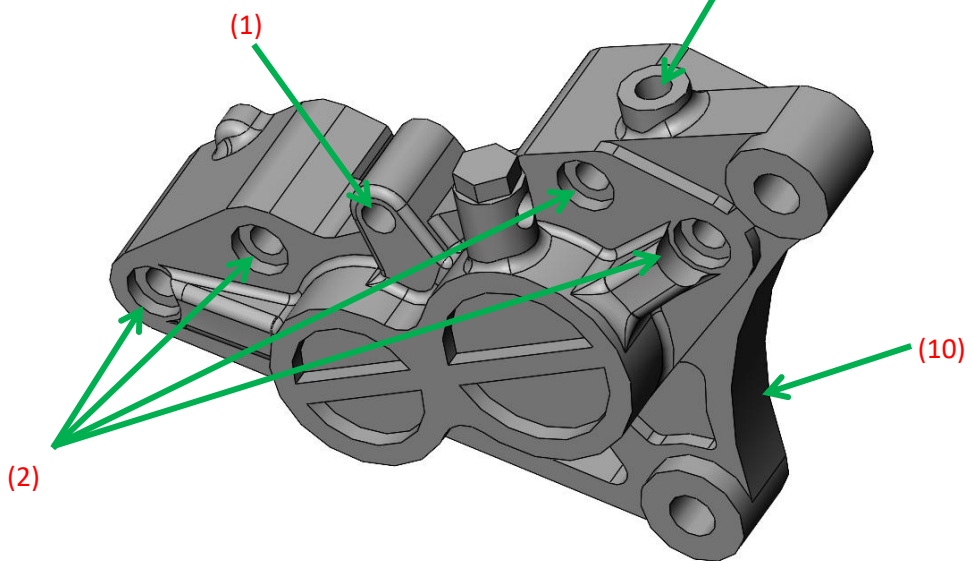

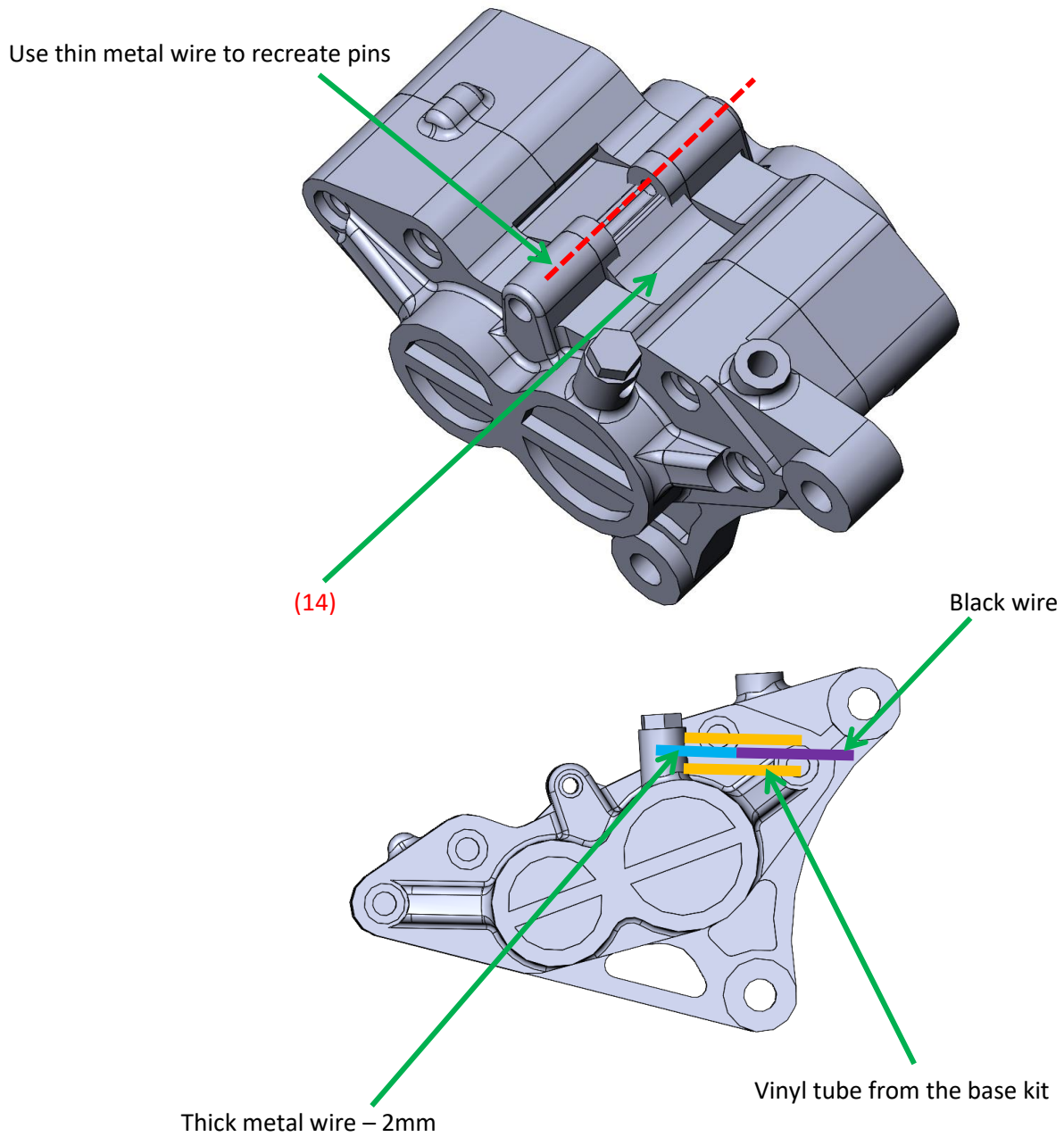
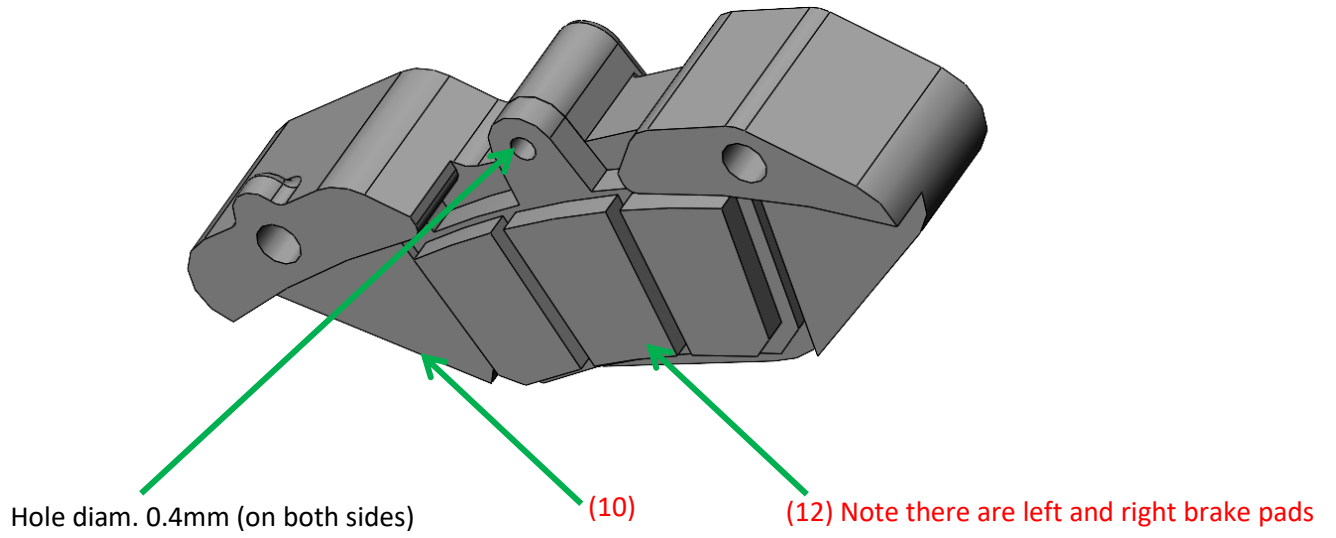

First attach the rotor to the rim, then install the rim to the front fork. In the last step attach brake calipers.

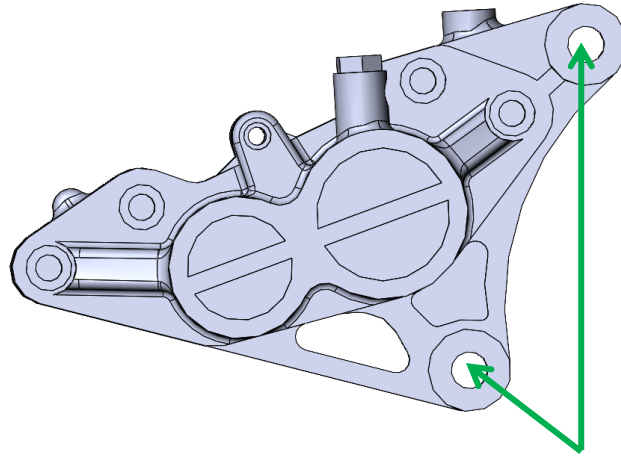

Use screws (4) to attach to the front fork